



TECHNICAL DATA SHEET
BENCHES
STEEL BENCHES





SERIES



BANC-H-1000



BANC-H-1500



BANC-H-2000

CHARACTERISTICS

Manufactured in steel tube of 1.5 mm thickness.

Powder-coated with Epoxy-polyester in grey RAL 7035. Minimum thickness of 50 micrometer.

Welded structure.

Great resistance.

PVC height-adjustable end cap.

Stackable.

With shoe rack.

METALLIC COLOURS

STANDARD COLOURS



RAL 5010
Gencana blue
Código HEX: #004f7c



RAL 7035
Luminous grey
Código HEX: #c5c7c4

GROUP 1



RAL 9010
Pure white
Código HEX: #f1ece1



RAL 3000
Red
Código HEX: #a72920



RAL 6034
Pastel turquoise
Código HEX: #7aacac

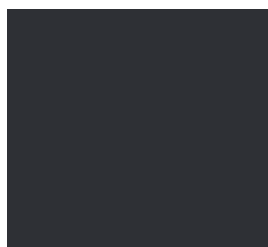

RAL 7016
Anthracite grey
Código HEX: #383e42

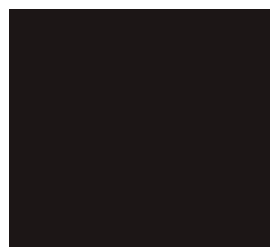

RAL 9005
Intense black
Código HEX: #0e0e10

GROUP 2

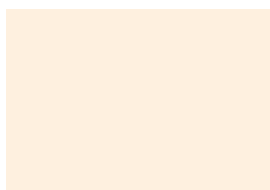

RAL 9001
Cream white
Código HEX: #e9e0d2



RAL 1017
Saffron yellow
Código HEX: #f6a950



RAL 1021
Rapeseed yellow
Código HEX: #f6b600



RAL 2004
Pure orange
Código HEX: #e25303



RAL 3017
Pink
Código HEX: #cb555d



RAL 3005
Wine red
Código HEX: #59191f



RAL 4005
Lilac
Código HEX: #76689a



RAL 6029
Mint green
Código HEX: #006f3d



RAL 5015
Sky blue
Código HEX: #007cb0



RAL 5023
Distant blue
Código HEX: #42698c



RAL 9006
White aluminium
Código HEX: #a1a1a0



RAL 7036
Platinum grey
Código HEX: #979392

OPTIONS

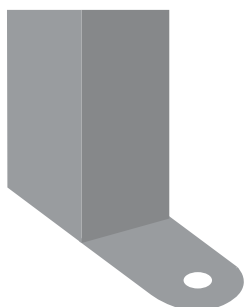

Floor fixing

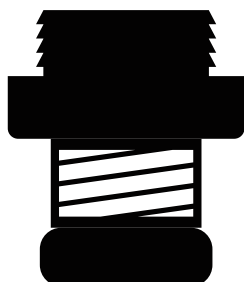

Legs adjustable

COMBINATIONS AND DIMENSIONS

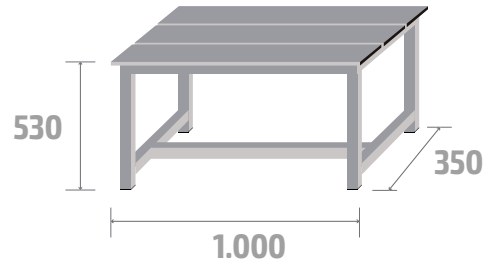

BANC-H-1000
12kg · 0,19m³

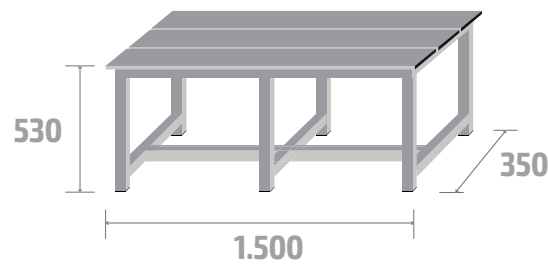

BANC-H-1500
18kg · 0,28m³

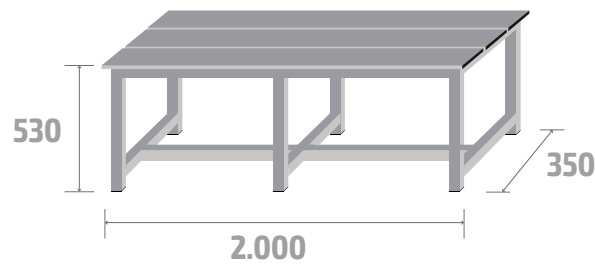

BANC-H-2000
24kg · 0,37m³